

# 30

## THE ASHTON

116 Plumrose Lane, Ft. Thomas KY 41075 / Ft Thomas Overlook / \$330,000

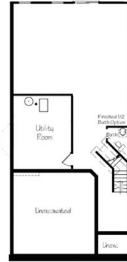

Lower level



Second floor



first floor

The Ashton built in the desirable Ft. Thomas Overlook community by Ashley blends the charm and tradition of Ft. Thomas with the conveniences and style desired by today's homebuyers. The exterior maintenance free townhomes allows all who live there to have the time to enjoy a carefree lifestyle, freedom to travel, and private wooded views bordering the Highland Country Club golf course. The beautiful Ashton floorplan was designed for all age groups. The two-story entry opens to the expansive dining and living rooms and continues on into the optional solarium. The gourmet kitchen offers an abundance of cabinets, great work space, and a delightful breakfast area. The elegant first-floor owner's suite offers a tray ceiling, gracious windows, a large walk-in closet and wonderful owner's bath. A deck off the solarium, a powder-room and first floor laundry closet complete the first level. The second floor of the Ashton offers either a grand guest area or second master suite...perfect for a roommate or guest. The large sleeping room offers two walk-in closets and opens to the ideal sitting area or office space depending on need. The bonus space can be finished as a third bedroom, large storage closet or attic space. Completing the second floor is a second full bath, balcony/overlook area, and additional storage closet. Buyers have the option of designing and finishing the lower level into a fabulous family/game room or a home theater and adding a half bath. A two-car garage, Pella Low E windows, a gas high efficiency furnace along with other special features completes this beautiful townhome built by Ashley. This townhome is available for sale. **Directions to Entry:** From 471 South/North to US-27/Ft. Thomas exit #2. Left off exit onto Alexandria Pike to Right on Blossom Lane.

**Ashley**  
CONSTRUCTION INC.

**Ashley Construction**

859-341-0050 / [www.ashleybuilders.com](http://www.ashleybuilders.com)

